

CSC MODELS

8 FOOT WIDE SERIES

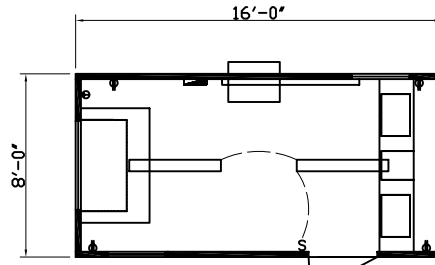

Model CSC 820

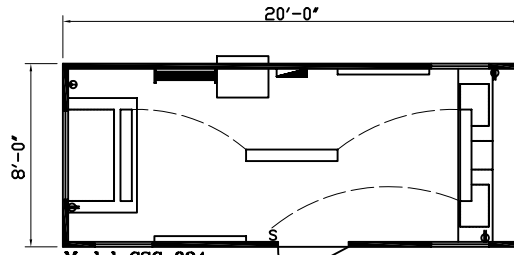

Model CSC 824

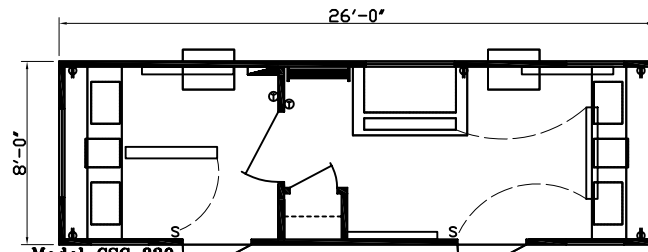

Model CSC 830
DOUBLE OFFICE

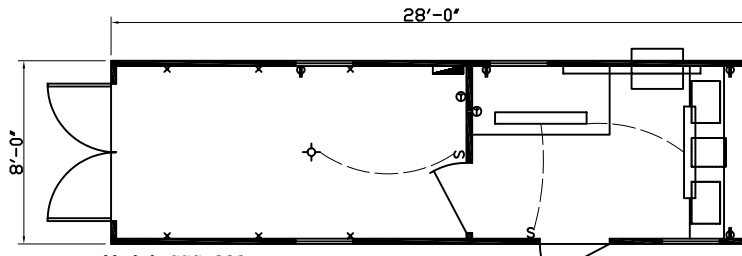

Model CSC 832
CARGO OFFICE

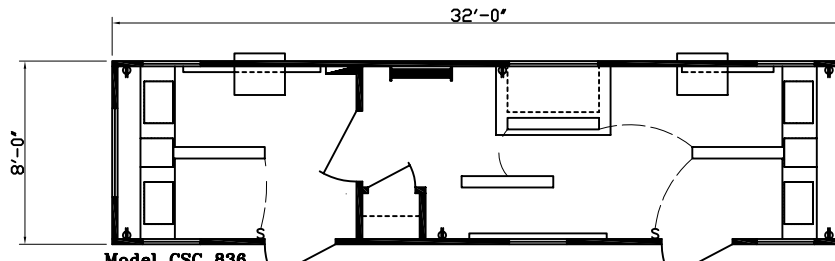

Model CSC 836
DOUBLE OFFICE

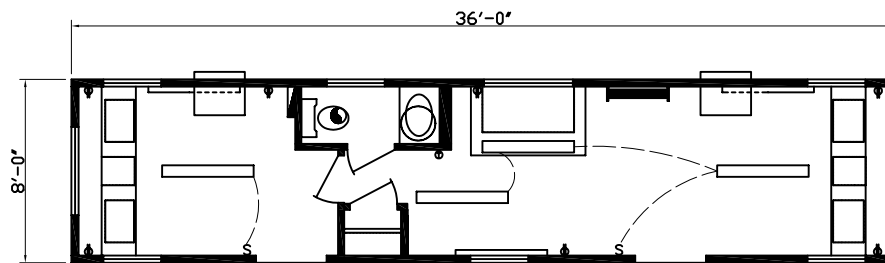

Model CSC 840
DOUBLE OFFICE

10 FOOT WIDE SERIES

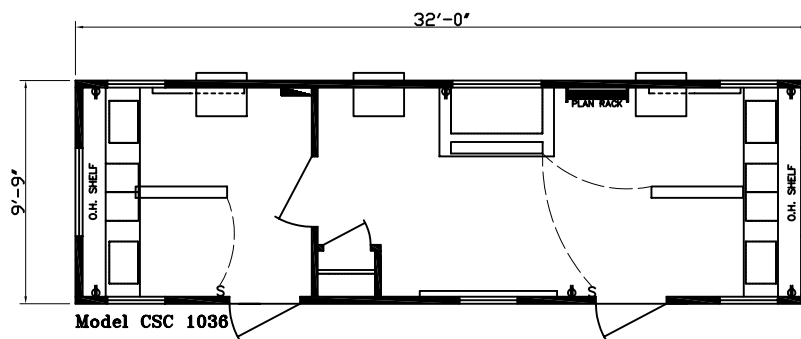
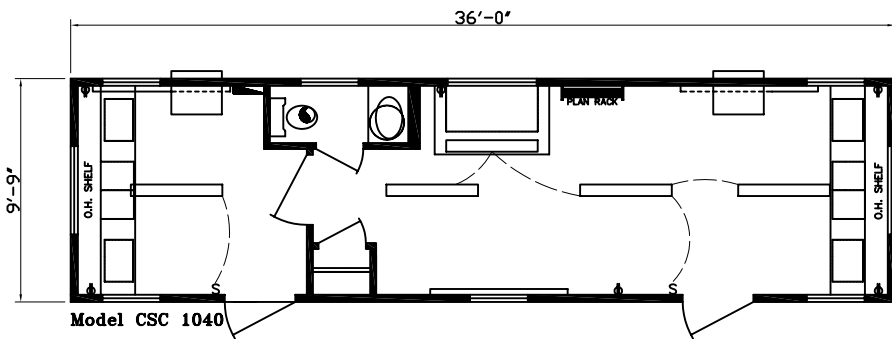
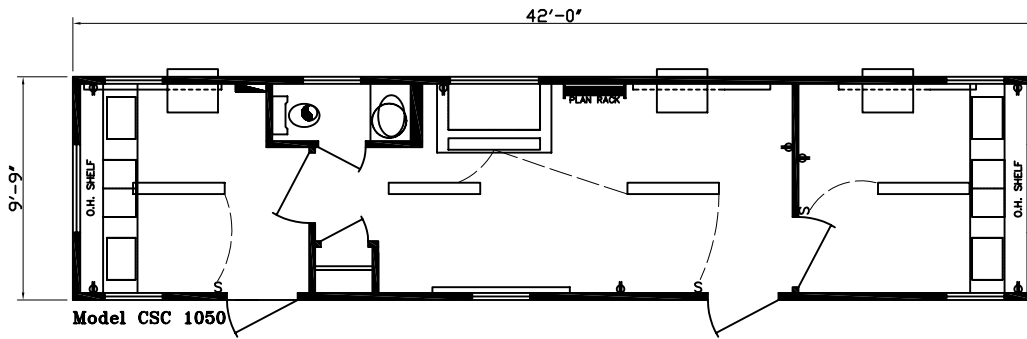
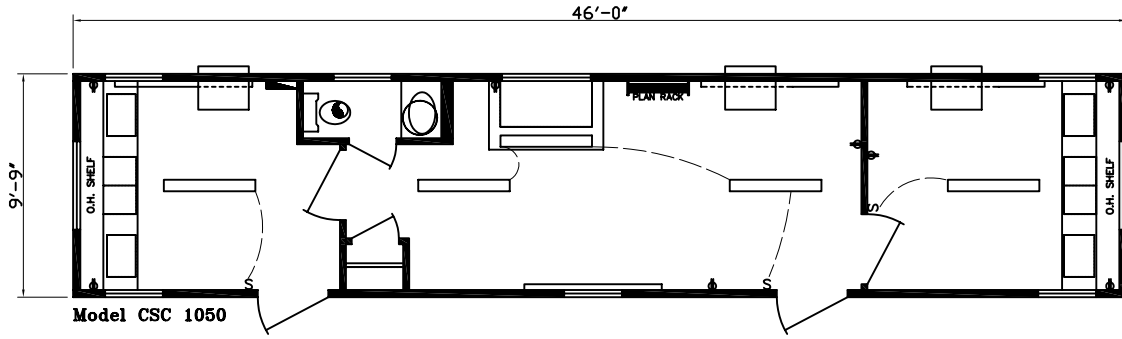

LEGEND

| | | | |
|--|-------------------------------|----------------|-----------------|
| | = 4' 2 TUBE FLUOR STRIP LIGHT | | = DUPLEX RECEPT |
| | = INCANDESCENT LIGHT | S | = SWITCH |
| | = SERVICE PANEL | S ₃ | = 3-WAY SWITCH |
| | = BASEBOARD HEATERS | | = WATER HEATER |
| | = A/C UNIT | | |

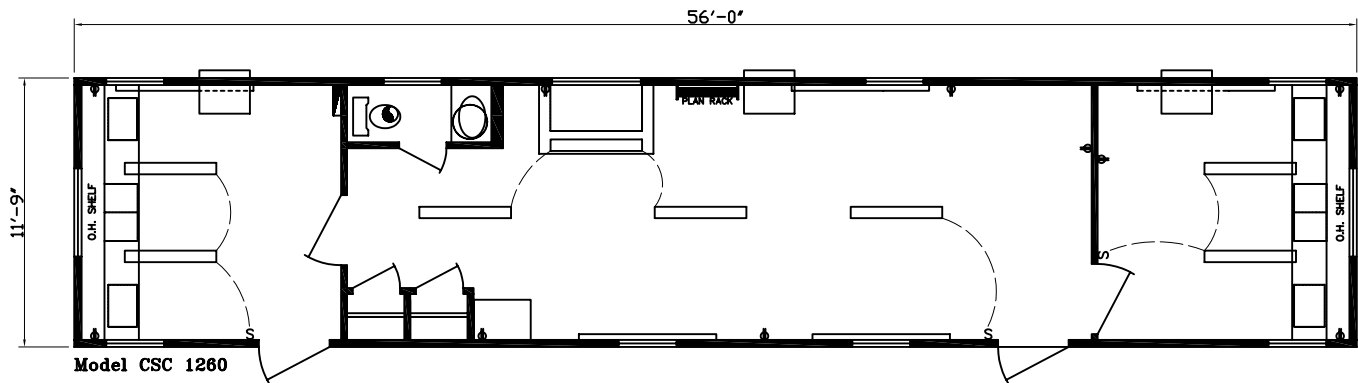
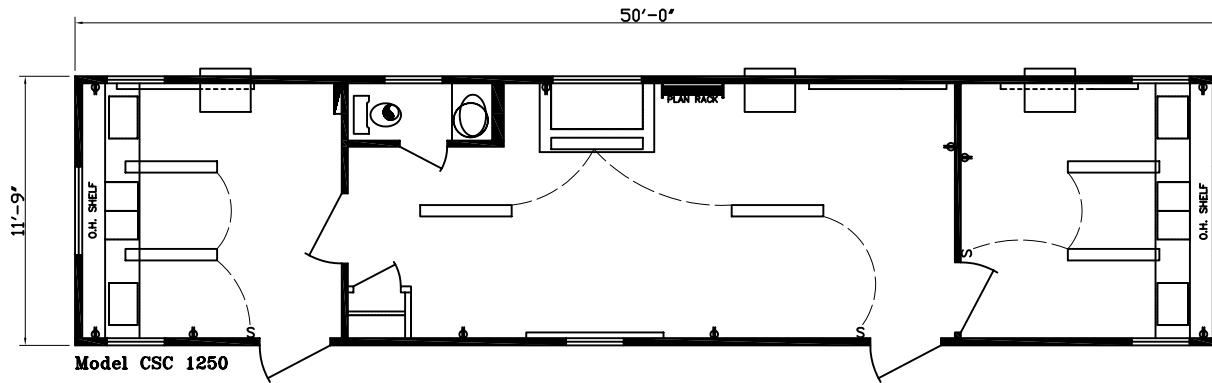
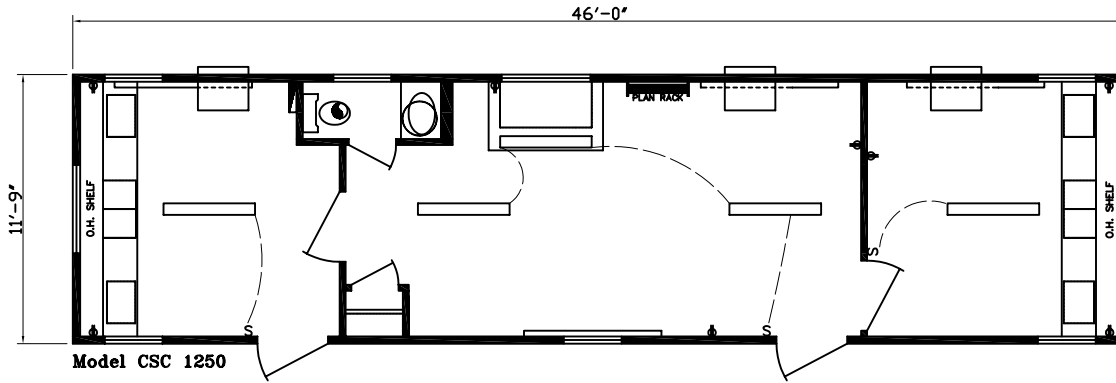
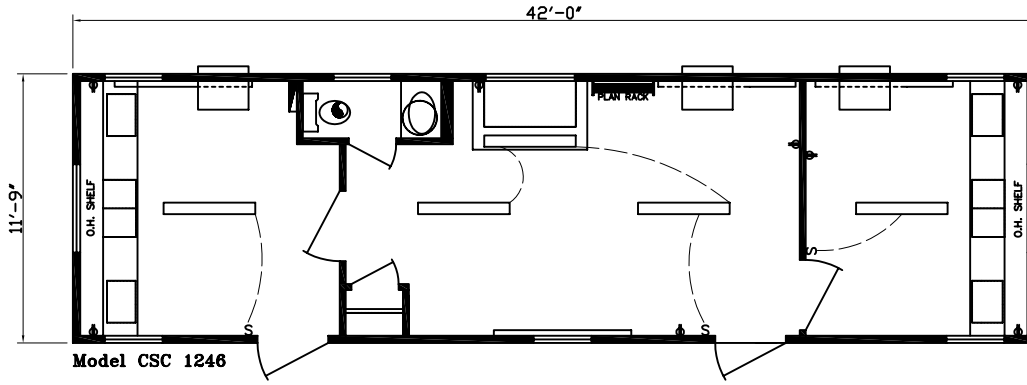

8 FOOT WIDE SERIES

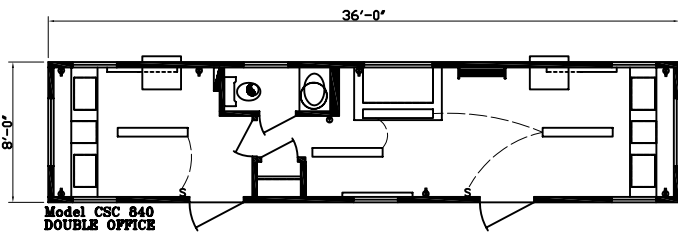
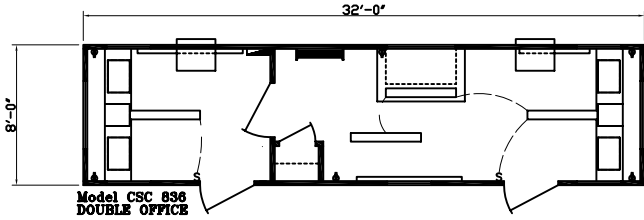
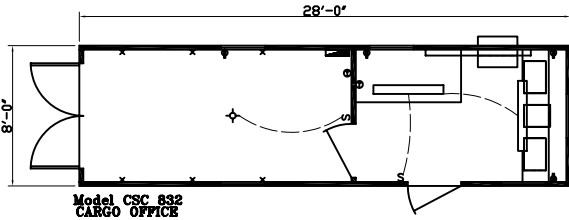
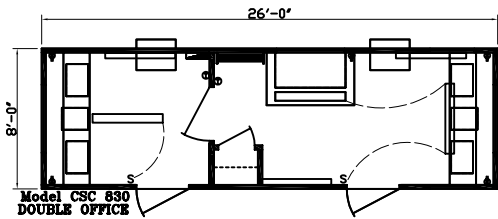
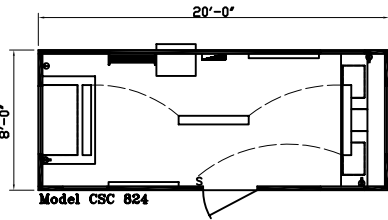
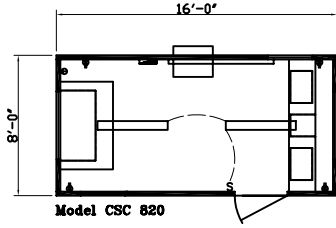

10 FOOT WIDE SERIES

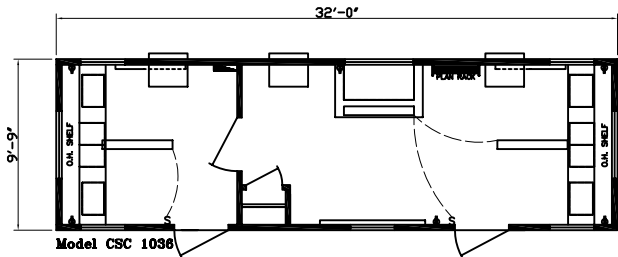
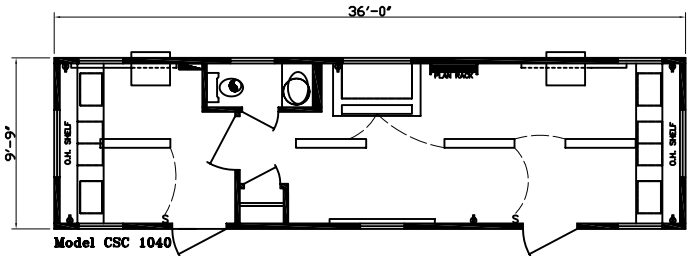
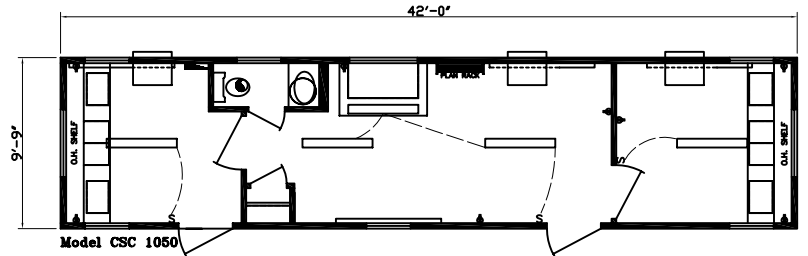
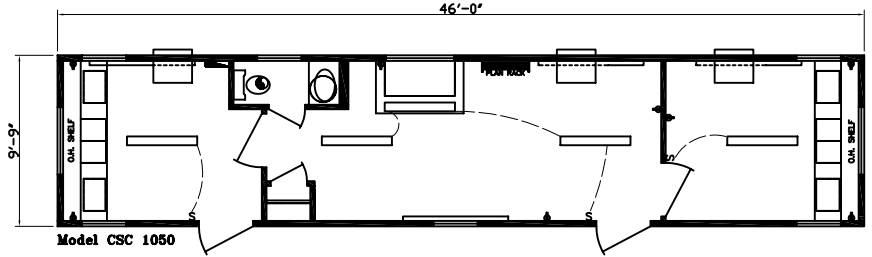

LEGEND

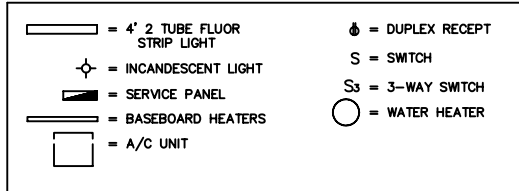

① FRAME Steel frame consists of 2 Junior I beams with 13 ga. steel outriggers and open web crossmembers spaced at 48" o.c. rear crossmember are solid 14 ga. steel. All frame parts are coated with corrosive resistant (black) paint. Temporary steel steps are at each door. (Optional)

② UNDERCARRIAGE : Axles, rims and 14-ply rated tires are new. 6000# capacity axles and electric brakes are standard on all axles.

③ EXTERIOR BOTTOM BOARD : .040 Asphalt impregnated bottom board or poly weave membran, covers the entire floor system and is located between the frame and underside of floor joist. In addition the wheel wells are lined with galvanized steel stone shields.

④ FLOOR JOIST : Joist are 2"x4" (8' wides) or 2"x6" (10', 12', and 14' wides) nominal #2 s.p.f. or better space at 16" o.c. or closer. 1"x4" transverse stringers at floor seams.

⑤ FLOOR INSULATION : Fiberglass blanket type insulation between floor joists R-11. Insulation is Kraft backed.

⑥ FLOOR DECKING : 5/8" thick A.P.A. rated Sturd-I- Floor underlayment plywood. Nailed & Glued

⑦ FLOOR COVERING : 1/8" v.c. tile is standard. Covering is securely affixed using waterproof adhesive. painted floors is optional.

⑧ WALL FRAMING : Studs are 2"x4" (nominal) #2 S.P.F. or better spaced at 16" o.c. Top Plate is 2"x4" and bottom plate is also 2"x4" Doors are double studded. Wall studs are nailed (2-3/8" ring shank) and secured with 30 ga. strapping every other stud top and bottom and at door and window joints doors are double studded w/header & jack stud.

⑨ WALL INSULATION : Fiberglass blanket type insulation between studs is R-11. Insulation is Kraft backed. (R-11 is used with 2"x4" wall option)

⑩ INTERIOR WALL COVERING : 1/4" Brich paneling is stapled and glued. End walls and partitions covered with 5/16" laminated vinyl gypsum. Gypsum is attached with wide crown staples and adhesive.

⑪ EXTERIOR WALL COVERING : Siding is .019" Aluminum prefinished. Top and bottom trim and corners posts are prefinished .019" Aluminum.

⑫ INTERIOR CEILING : Ceiling material is 1/2" gypsum with a white stucco finish. This is fastened securely to roof rafters with wide crown staples and screws.

⑬ ROOF INSULATION : Fiberglass blanket type insulation between rafters is R-14. Insulation is Kraft backed.

⑭ ROOF FRAMING : Framing consists of 30# live load bow trusses, spaced 16" o.c. with 2"x4" center beam running full length.

⑮ EXTERIOR ROOF SHEATHING : (Optional) sheathing is standard W/ E.P.D.M. Rubber Roofing System.

⑯ ROOF COVERING : 30ga. Galvanized steel covers the entire roof assembly. All seams and edges are sealed with roof coating.

⑰ EXTERIOR DOORS : Doors are a sandwich type construction with .019 aluminum on both faces with a core of foam and wood. extruded aluminum surrounds the assembly. Door lite is a fixed tempered glass single pane window measuring 10"x10". Temporary steel steps at each door is optional.

All Comercial Structures Buildings are constructed by people who take pride in their work. Buildings are inspected by the strictest of quality control standards before delivery to you. we have pride in our buildings.

SHARE THE PRIDE - BUY THE BEST

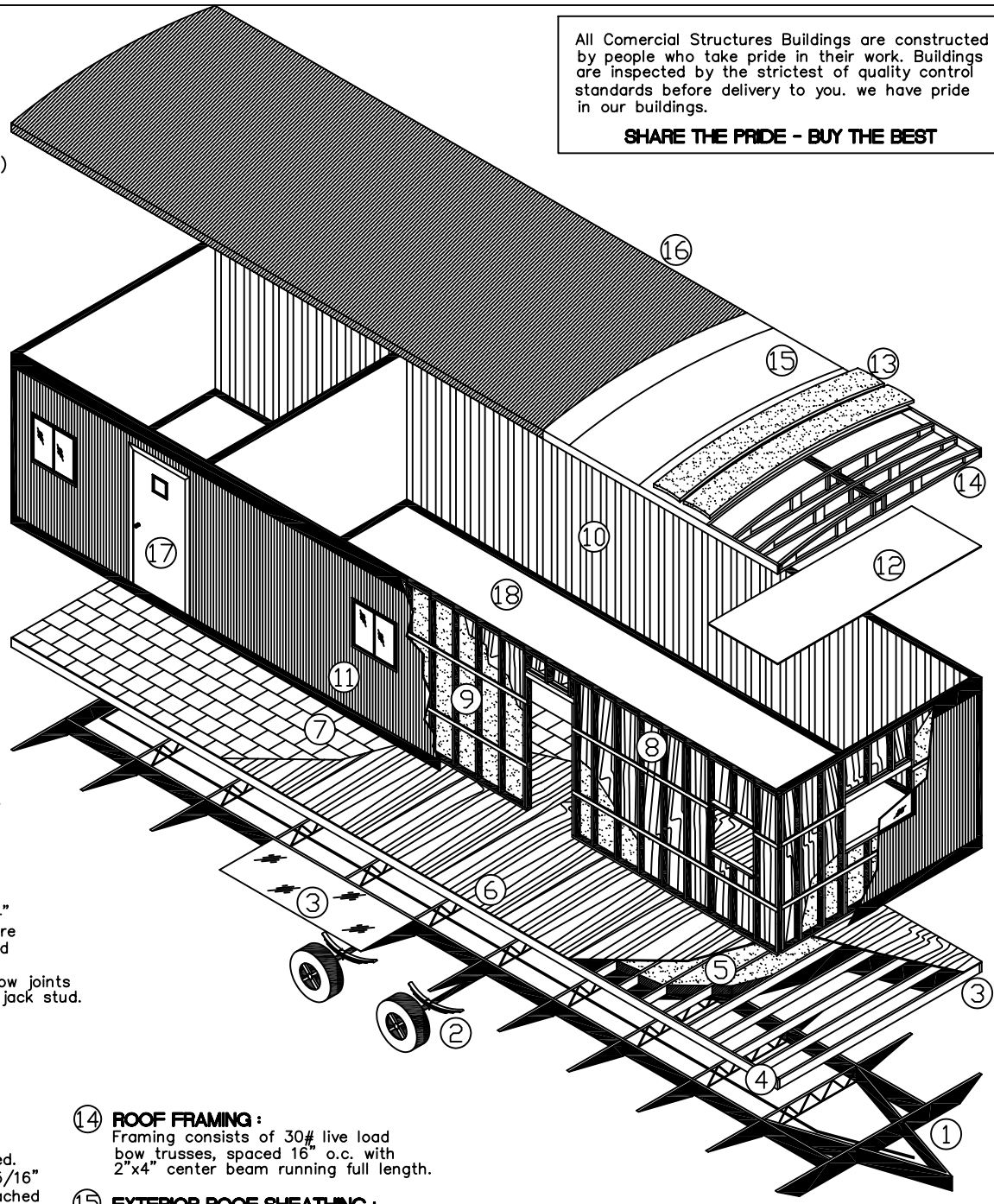

⑱ WINDOWS : Windows are single pane horizontal sliders with an aluminum frame. Windows are installed with putty tape and silicone based sealant.

⑲ ELECTRICAL SERVICE PANEL : Pre-wired service entrance panel is equipped with a main breaker. Lights, receptacles, ect. are pre-wired. All electrical components are U.L. approved and wired to National Electrical Code. The service panel is built in.